



# CHAFING FUEL IDEAL USAGE

RECOMMENDED APPLICATION	STERNO FUEL	HEAT LEVEL	BURN TIME
-------------------------	-------------	------------	-----------



CHAFING DISH



Safe Heat® w/Power Pad®  
#10112, #10114, #10370



2, 4, 6 HR



Ethanol Gel  
#20612



2 HR



Handy Wick®  
#10364, #10366, #10368



4, 5, 6 HR



Stem Wick  
#10102



6 HR



Handy Fuel® Methanol Gel  
#20660



2 HR

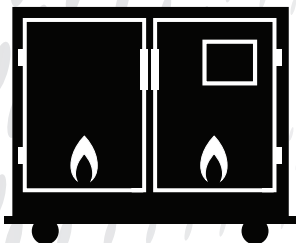

BANQUET CART  
(INSULATED)



Stem Wick  
#10102



6 HR



Handy Wick®  
#10364, #10366, #10368



4, 5, 6 HR

Always follow manufacturer's instructions for maximum number of fuel cans & placement.

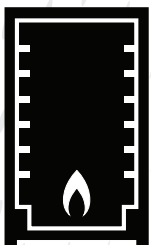

HOT BOX  
(NOT INSULATED)



Ethanol Gel  
#20612



2 HR



Stem Wick  
#10102



6 HR



Handy Wick®  
#10364, #10366, #10368



4, 5, 6 HR

Always follow manufacturer's instructions for maximum number of fuel cans & placement.

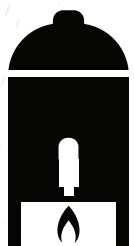

BEVERAGE URN



Stem Wick  
#10100, #10102



2, 6 HR



Handy Wick®  
#10364, #10366, #10368



4, 5, 6 HR



VIEW A SHORT  
CHAFING FUEL  
TRAINING VIDEO

### HEAT PERFORMANCE GUIDE



MODERATE



MEDIUM HIGH



MAXIMUM



www.Sterno.com





# CHAFING FUEL SAFETY TIPS

**ALWAYS**



**ALWAYS** use **CAUTION** when handling **OPEN FLAME** products



**ALWAYS** use a blunt object, such as a spoon, to pry off the lid



**ALWAYS** cup hand over lid when opening can



**ALWAYS** remove excess gel from lid if it is being used as a regulator

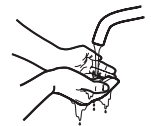

**ALWAYS** wash fuel residue from hands

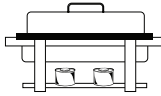

**ALWAYS** place the can securely underneath the chafing dish or beverage urn before lighting

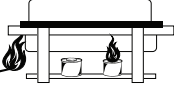

**ALWAYS** use a long handled match or butane lighter to light cans



**ALWAYS** use a can cap, snuffer paddle, regulator or saucer to extinguish flame



**ALWAYS** wait until can is cool before touching

**NEVER**



**NEVER** use a sharp knife to pry off lid



**NEVER** use a lit can to light another can



**NEVER** carry lit cans

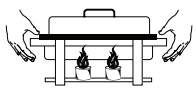

**NEVER** carry chafing dishes or beverage urns with lit cans



**NEVER** touch cans while still hot



**NEVER** allow decor, loose clothing, napkins or tablecloths near flame



**NEVER** allow hair to fall near flame



**NEVER** use hands to extinguish flame



**NEVER** blow out flame to extinguish



VIEW A SHORT  
CHAFING FUEL  
TRAINING VIDEO





# CHAFING DISH SET UP INSTRUCTIONS

**SIMPLE AS  
1-2-3!**

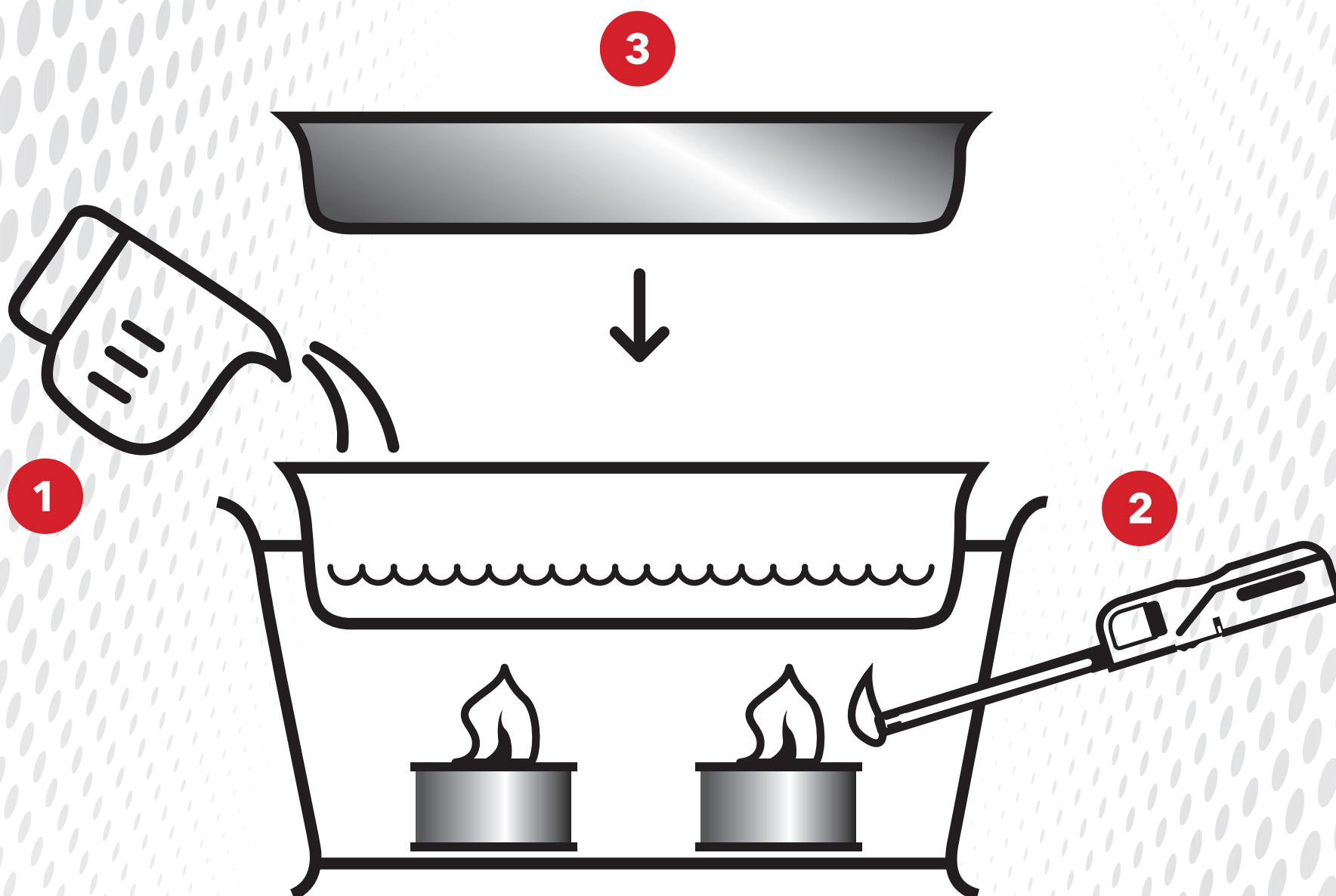

**Additional instructions Inside**

1. Fill water pan with hot tap water approximately 1" deep.
2. Place Sterno® Canned Heat in holders, then light.
3. Place food pan(s) in water pan. Serve!

Use chafing dishes in well-ventilated areas. Replenish water as needed. Be cautious of hot steam.

**REFER TO CANNED HEAT LABEL FOR  
INSTRUCTIONS AND WARNINGS.**



VIEW A SHORT  
CHAFING FUEL  
SET UP VIDEO







# BUTANE SAFETY TIPS

All Sterno butane stoves are designed for indoor and outdoor use by licensed foodservice establishments. These stoves are not for household use.

Any butane stove, regardless of manufacturer, can produce carbon monoxide, which has no odor. Never use a butane stove in an enclosed space, such as a camper, tent, car, or home.

## BUTANE STOVE ELEMENTS

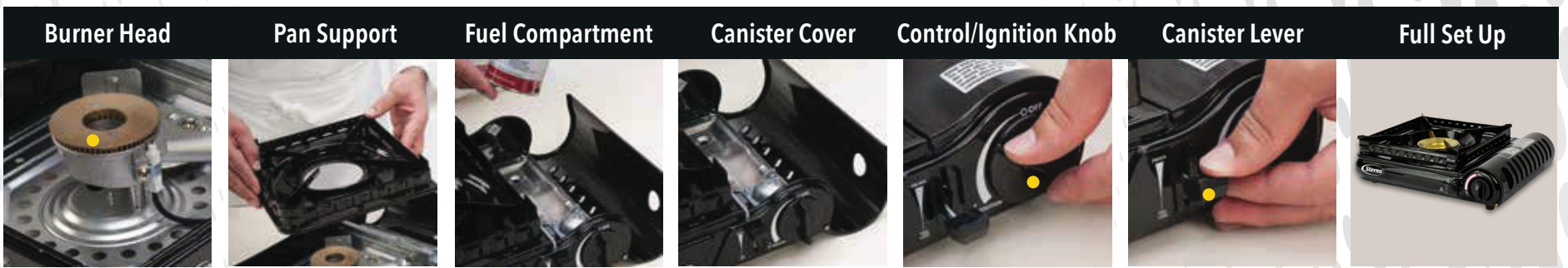

**ALWAYS**

- ALWAYS** keep out of reach of children.
- ALWAYS** keep the stove clear and free of combustible materials, gasoline and other flammable vapors and liquids.
- ALWAYS** use the stove in a well-ventilated, open space.
- ALWAYS** provide adequate clearances around air openings into the combustion chamber.
- ALWAYS** use UL approved Sterno branded butane canisters to power the stove.
- ALWAYS** clean stove frequently to avoid grease build-up.
- ALWAYS** remove butane canister from stove before storing.
- ALWAYS** store butane canisters in a well-ventilated space, out of the reach of children.

**NEVER**

- NEVER** use a butane stove in an enclosed space, such as a camper, tent, car, or home.
- NEVER** use 2 or more stoves adjacent to each other.
- NEVER** use the stove without the pan support in place.
- NEVER** use a pan larger than 10.5" as this will cover the fuel compartment and cause the canister to overheat.
- NEVER** use two or more stoves covered by a single pan or metal sheet.
- NEVER** use the stove near flammable materials or combustible vapors.
- NEVER** install or remove butane cartridges while stove is lit.
- NEVER** use the stove in spaces that contain volatile airborne combustibles.

### FOR YOUR SAFETY IF YOU SMELL GAS:

1. Do not attempt to light the appliance
2. Extinguish any open flame.
3. Disconnect the stove from the fuel supply
4. Evacuate enclosure



[www.Sterno.com](http://www.Sterno.com)

VIEW A SHORT  
BUTANE STOVE  
TRAINING VIDEO







# SPEEDHEAT SAFETY



Sterno SpeedHeat® is a food-warming system that includes a specially-designed base, tray and packets that **MUST** be used together. Using Sterno SpeedHeat Refills with any other equipment, such as in a chafing dish water pan, regardless of the type, material or design, is a misuse of the product that may cause personal injury.

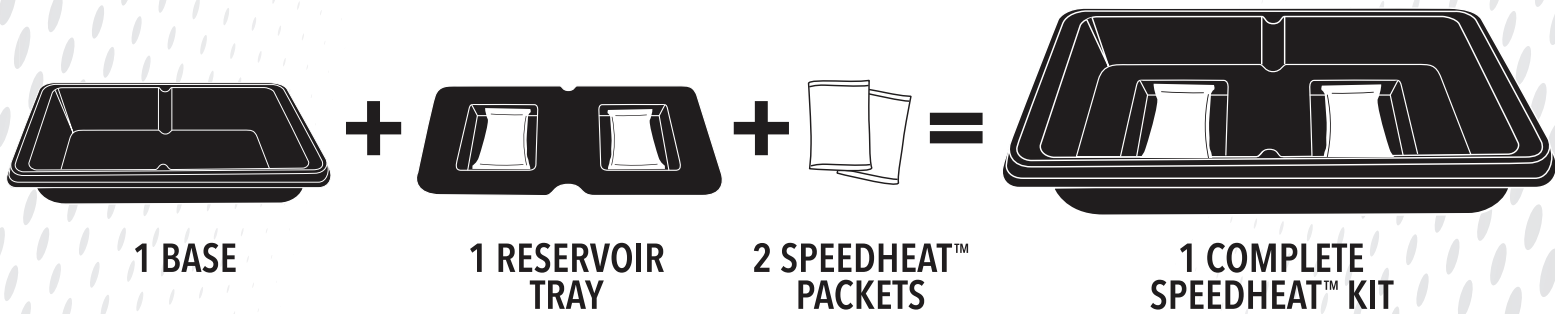

## SETS UP IN MINUTES | KEEPS FOOD HOT UP TO 1 HOUR RECYCLE AFTER USE

- ALWAYS** read **ALL WARNINGS AND INSTRUCTIONS** on the back of the SpeedHeat® packet packaging prior to use.
- ALWAYS** use SpeedHeat in a well-ventilated area where air flow is circulating and not trapped or limited within a small or enclosed space to prevent false triggering of Carbon Monoxide Detectors.
- NEVER** block airflow to where SpeedHeat is operating. If space heaters, furnace, or any gas-fueled or heat-producing appliance or device are being used during the operation of SpeedHeat, make sure that they have sufficient room for ventilation.
- NEVER** use SpeedHeat inside a camping tent, automobile, recreational vehicle, or trailer of any size or type.

- 1** ADD TRAY TO BASE.
- 2** PLACE STEAM STOPPER ACROSS CENTER OF BASE. OPEN 2 PACKETS AND PLACE 1 IN EACH SMALL RESERVOIR.
- 3** WHEN READY TO SERVE GUESTS, ACTIVATE PACKETS BY FILLING EACH SMALL RESERVOIR TO TOP WITH WARM WATER.
- 4** ADD FILLED, HOT FOOD PANS. SERVE!  
KEEPS FOOD HOT UP TO 1 HR



VIEW A SHORT  
SPEEDHEAT  
TRAINING VIDEO

